

## 6 ½' PRE-LIT CHRISTMAS TREE

model no. 151-8408-4 | Toll-free number: 1-866-827-4985

IMPORTANT: Please read this manual carefully before assembly and save it for reference.

### TREE ASSEMBLY INSTRUCTIONS

Carefully follow the instructions below to quickly and easily set up your tree.

1. Before you start to assemble your tree, choose an appropriate location near a wall outlet. Do not plug the adaptor into the wall outlet until all of the steps below are completed.
2. First assemble the tree stand and place on a level surface. (See Fig. A)

**Fig. A - Tree Stand Assembly**

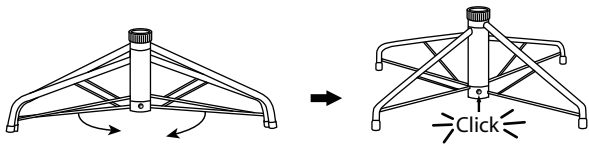

Swivel the legs of the stand until they snap into position. The legs should be evenly spaced once this step is complete. Place the tree stand on a level surface.

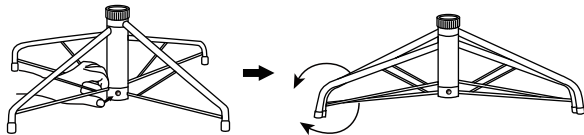

To close the stand, press the metal button and fold the legs together.

**Fig. B - Tree and Light Assembly**

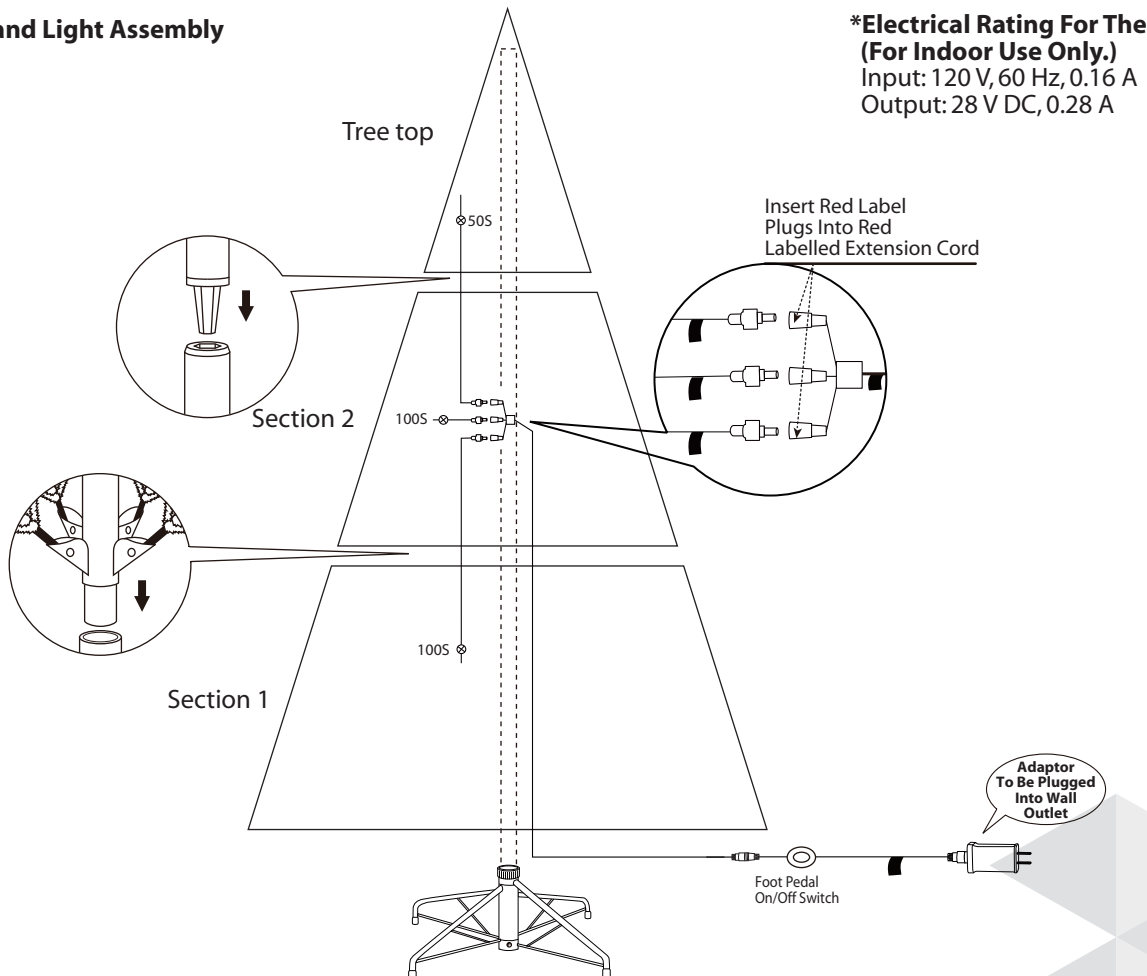

**\*Electrical Rating For The Tree (For Indoor Use Only.)**  
Input: 120 V, 60 Hz, 0.16 A  
Output: 28 V DC, 0.28 A

3. Each tree section is numbered with a sticker. Please identify all sections before assembling.
4. Assemble the tree from the bottom to the top. Start with the bottom section. Remove the protective cap before inserting it into the already pre-assembled stand. Before proceeding to the next step, make sure the pole is firmly inserted and secured into the stand.
5. Continue by inserting the upper tree section(s) into the lower section(s) until inserting the tree top.

6. Allow branches to fall into place or gently pull up and out. When adjusting branches, be sure that all wires are free of branch hinges.
7. Connect the light strings as per the colour labels indicated in **Fig. B** and insert adaptor plug into the wall outlet. Your entire tree should now be lit. If some bulbs flicker or do not light, search for any loose plugs and/or broken, loose or missing bulbs. Replace bulbs promptly in order to maintain the performance and life expectancy of your pre-lit tree.
8. Begin to shape the branches and tips, working from the bottom to the top. Start with tips farthest from the pole and fan out one to the right, one to the left and one at the centre of the main stem. **(See Fig. C)**

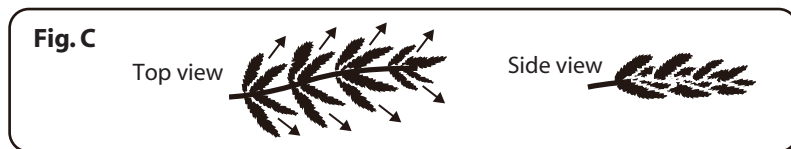

9. Once the shaping of the entire tree is completed, slightly upswEEP all branch tips so a uniform look may be obtained. Shift branches to fill any gaps. Your Christmas tree is now complete and ready to be decorated.

## STORAGE INSTRUCTIONS

1. For pre-lit trees, first unplug adaptor from the wall outlet, remove all ornaments and decorations. Disconnect light cords between each section of the tree.
2. Disassemble the tree from the top to the bottom. Start with the tree top: gently lift straight up to remove from section below, and fold all branches toward the pole.
3. In case of difficulty separating the tree pole (trunk), apply a small amount of lubricant at the joint and gently twist the upper pole in both directions. Lift up the upper pole again.
4. Continue by gently lifting straight up each section from the section below and folding all branches toward the pole until the bottom section is removed from the tree stand.
5. Carefully place all tree sections into shipping box and tape it shut.
6. When not in use, please store your tree in a cool, dry place away from sunlight. Exposing your tree to excessive heat or humidity may damage your tree.
7. Keep out of reach of pets and children.

### For pre-lit trees, if the tree does not illuminate:

1. Please check to make sure that all plugs are properly connected according to the colour labels indicated in **Fig. B** and that the power adaptor is plugged into the wall outlet. Refer to assembly guide for instructions. (If the tree comes with a foot pedal, try stepping on the ON/OFF button.)
2. Please check for loose, broken or missing light bulbs and replace as needed.
3. When multiple products are connected together, do not exceed the lowest of the indicated maximum wattage on the cord tag near the connected product's receptacle.

### Loose Hinge Pin

1. Extra hinge pins are included for repairing the hinges. Place the branch into the slot of the bracket.
2. Insert a new hinge pin through the hole and secure using the retainer washer. **(See Fig. D)**

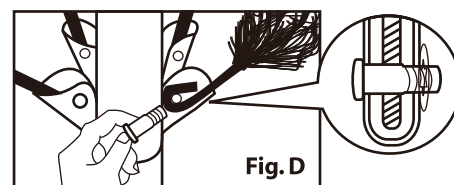

## SPARE PARTS

Each tree includes hinge pins/washers, and for pre-lit trees, spare bulbs which are included. If extra parts are needed, please contact our customer service centre.



## CAUTION:

To reduce the risk of fire and electric shock:

- a) Use only the power supply that was provided with this product. Using a different adaptor will damage the lights and may cause fire, or electric shock hazard.
- b) Do not install on trees having needles, leaves or branch covering of metal or materials which look like metal.
- c) Do not mount or support strings in a manner that can cut or damage wire insulation.

This product carries a five (5) year warranty against defects in workmanship and materials. Noma Canada agrees to replace a defective product, within the stated warranty period, when returned to the place of purchase with proof of purchase. This product is not guaranteed against wear or breakage due to misuse and/or abuse.

Made in China

Imported by

Noma Canada, Toronto, Canada M4S 2B8

DATE CODE: 22321

