

## NEED HELP?

DO NOT RETURN TO STORE. PLEASE VISIT US AT:  
[www.polygroupstore.com](http://www.polygroupstore.com) OR 1-888-919-0070



## TREE ASSEMBLY INSTRUCTIONS

Thank you for purchasing your new tree from **Polygroup®!**

This tree comes with Quick Set® technology - allowing you to set up your tree and light it up in minutes!

Carefully follow the instructions below on how to set up your tree quickly and easily.

1. Before you start assembling your tree, choose an appropriate location near a wall outlet.
2. Assemble the tree stand and place on a level surface. **(See Fig. A)**

**Fig. A - Tree Stand Assembly**

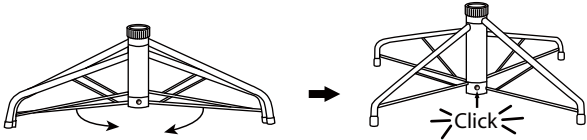

Pull apart the legs of the stand so that they are snapped into an x-shape. Place the tree stand on a level surface.

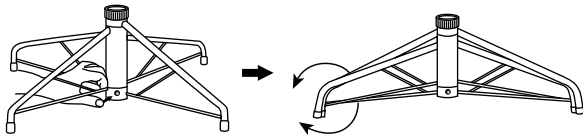

To close the stand, press the metal button and fold the legs together.

**Fig. B - Tree and Lights Assembly**

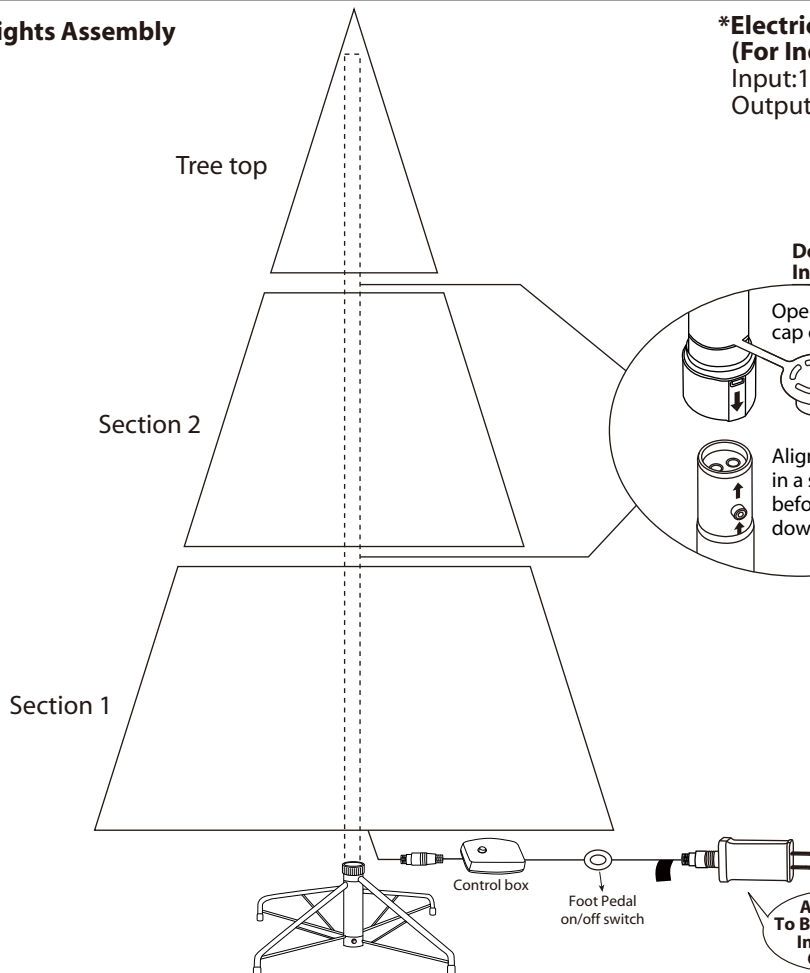

**\*Electrical Rating For The Tree  
(For Indoor Use Only)**

Input: 120 V AC, 60 Hz, 0.38 A  
Output: 29 V DC 0.621 A

**Do Not Tamper  
Internal Parts**

Open the  
cap cover

Align both arrows  
in a straight line  
before sliding  
down to insert

**Adapter  
To Be Plugged  
Into Wall  
Outlet**

3. Each tree section is numbered with a sticker. Please identify all sections before assembling.
4. Assemble the tree from bottom to the top. Start with the bottom section by inserting it into the assembled stand. Make sure the pole is firmly inserted and secured.
5. Remove the protective cap of upper sections before inserting lower sections. Follow the direction of the arrow marked on the adapter to insert.
6. Allow branches to fall into place or gently pull up and out. When adjusting the branches, be sure that all wires are free of branch hinges.
7. Just plug the adapter (connecting with the tree power cord) into the wall outlet. **(See Fig. B)** Your entire tree should now be lit. If some bulbs flicker or do not turn on, search for any loose plugs and/or broken, loose or missing bulbs. Replace bulbs promptly in order to maintain the performance and life expectancy of your pre-lit tree.

- Begin to shape the branches and tips working from the bottom to the top. Start with tips furthest from the pole and fan out from the side before moving towards the middle of the branch. **(See Fig. C)**

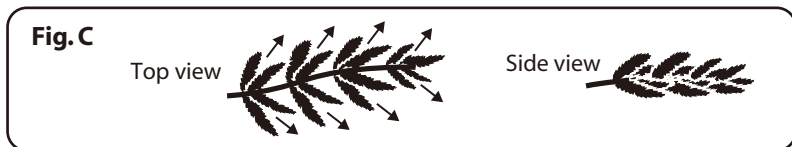

- This is a Simple Shape® tree and no shaping is required. After you finish shaping the tree, slightly upsweep all branch tips for a uniform look. Shift branches to fill any gaps. Your Christmas tree is now complete and ready to be decorated.

## STORAGE INSTRUCTIONS

- Unplug adapter from the wall outlet first before removing all ornaments and decorations.
- Disassemble the tree from the top to the bottom. Start with the tree top and gently lift straight up to detach from section below. Fold all branches toward the pole.
- Continue by gently lifting straight up each section(s) from the section below and fold all branches toward the pole until the bottom section is removed from the tree stand. Cover the protective cap on the poles to avoid damaging the internal parts. **(See Fig. D)**
- Carefully place all tree sections into shipping box and tape it shut.
- When not in use, please store your tree in a cool, dry place away from sunlight. Exposing your tree to excessive heat or humidity may damage your tree.

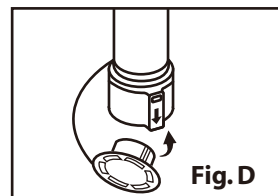

## TROUBLESHOOTING TIPS

### For pre-lit trees, if the tree does not illuminate

- Please check to make sure that all plugs are properly connected and adapter is plugged into the wall outlet. (If the tree comes with a foot pedal, try stepping on the on/off button).
- Turn the poles gently to make sure pole to pole are connected into place.
- Check for loose connection between light string plugs and extension cords.
- Please check for loose, broken or missing light bulbs and replace as needed.

### Loose hinge pins

- Extra hinge pins are included for repairing the hinges. Place the branch into the slot of the bracket.
- Insert a new hinge pin through the hole and secure using the retainer washer. **(See Fig. E)**

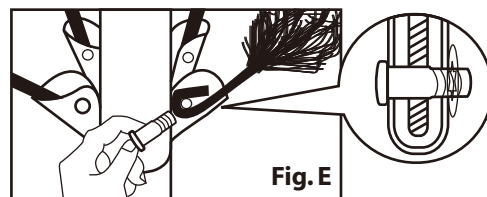

## SPARE PARTS

Each tree includes hinge pins/washers, and for pre-lit trees spare bulbs are also included. If extra parts are needed, please contact our customer service center.

## HOW TO USE THE DUAL COLOR LIGHT CONTROLLER :

Press the selector button on the “Dual Color Light Controller” to select among:

- CLEAR-MULTI:FADING;**
- CLEAR:FADING;**
- CLEAR-MULTI:ALTERNATING;**
- CLEAR:STEADY;**
- CLEAR-MULTI:SLOW FADING;**
- MULTI:STEADY;**
- MULTI:FADING;**
- COMBINATION.**

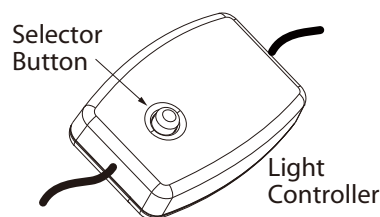

## IMPORTANT SAFETY INSTRUCTIONS

When using electrical products, basic precautions should always be followed including the following:

- READ AND FOLLOW ALL SAFETY INSTRUCTIONS.**
- Do not use seasonal products outdoors unless marked suitable for indoor and outdoor use. When products are used in outdoor applications, connect the product to a Ground Fault Circuit Interrupting (GFCI) outlet. If one is not provided, contact a qualified electrician for proper installation.
- This seasonal use product is not intended for permanent installation or use.
- Do not mount or place near gas or electric heaters, fireplaces, candles or other similar sources of heat.
- Do not secure the wiring of the product with staples or nails, or place on sharp hooks or nails.
- Do not let lamps rest on the supply cord or on any wire.
- Unplug the product when leaving the house, or when retiring for the night, or if left unattended.
- This is an electric product – not a toy! To avoid risk of fire, burns, personal injury and electric shock it should not be played with or placed where small children can reach it.
- Do not use this product for other than its intended use.
- Do not hang ornaments or other objects from cord, wire, or light string.

- k. Do not close doors or windows on the product or extension cords as this may damage the wire insulation.
- l. Do not cover the product with cloth, paper or any material not part of the product when in use.
- m. The supply cord cannot be replaced. If the cord is damaged the product should be scrapped.
- n. The lamps of this product are not replaceable. Do not attempt to change or modify the lamps.
- o. For LED string only. To reduce the risk of fire or electric shock, do not attempt to replace lamps or modify string.
- p. Read and follow all instructions that are on the product or provided with the product.

q. **SAVE THESE INSTRUCTIONS**  
**USE AND CARE INSTRUCTIONS**

- a) Before using or reusing, inspect product carefully. Discard any products that have cut, damaged, or frayed wire insulation or cords, cracks in the lampholders or enclosures, loose connections, or exposed copper wire.
- b) When storing the product, carefully remove the product from wherever it is placed, including tree, branches, or bushes, to avoid any undue strain or stress on the product conductors, connections, and wires.

**CAUTION:**

- 1. To reduce the risk of fire and electric shock:
  - a) Use only the power supply that was provided with this product;
  - b) Do not install on trees having needles, leaves or branch covering of metal or materials which look like metal;
  - c) Do not mount or support strings in a manner that can cut or damage wire insulation.
- 2. Use only the adaptor supplied with this product. Using a different adaptor will damage the lights and may cause fire, or electrical shock hazards.

**CUSTOMER SERVICE FOR CHRISTMAS TREES**

For any questions, assistance, or missing parts, **Do Not Return To Place Of Purchase.** Please contact us at 1-888-919-0070 or visit our website at [www.polygroupstore.com](http://www.polygroupstore.com). One of our customer service representatives will be happy to assist you.

Tree ID#: \_\_\_\_\_

Customer Name: \_\_\_\_\_

Tree UPC#: \_\_\_\_\_

Address(No P.O. Boxes): \_\_\_\_\_

Store Purchased: \_\_\_\_\_

City & State: \_\_\_\_\_

Specify Problem: \_\_\_\_\_

Zip Code: \_\_\_\_\_

\_\_\_\_\_

Day Phone: \_\_\_\_\_

\_\_\_\_\_

Date Purchased: \_\_\_\_\_

**TREE ID# IS LOCATED ON END PANEL OF BOX. TREE ID# IS REQUIRED WHEN REQUESTING REPLACEMENT PARTS.**