

TREE ASSEMBLY INSTRUCTIONS

Congratulations on purchasing your new tree from **Polygroup®**! This tree comes with Quick Set® and Simple Shape™ technology which takes less than 10 minutes to set up and light up!

Carefully follow the instructions below on how to assemble your new tree quickly and at ease:

1. Choose an appropriate location near a wall outlet.
2. Assemble the tree stand (**Fig. A**) and place on a level surface.

Fig. A - Tree Stand Assembly

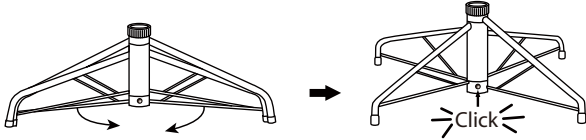

Pull apart tree stand legs until they snap and form an 'X' shape.

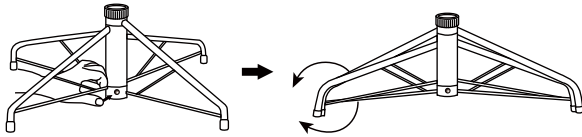

To close the stand, press the metal button and fold the legs together.

Fig. B - Tree and Light Assembly

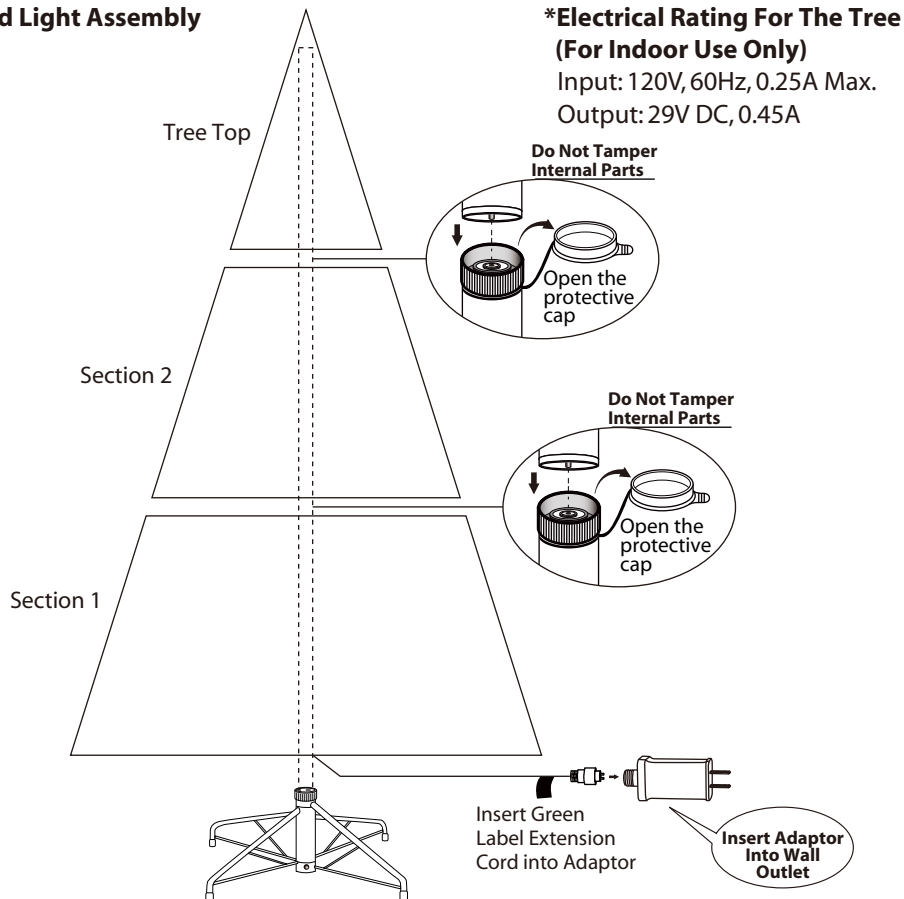

3. Each tree section is numbered with a sticker. Please identify all sections before assembling.
4. Assemble the tree from the bottom to the top. Remove protective cap, and insert the pole to the assembled stand until firmly secured. Be sure that all wires are free of branch hinges.
5. Insert green label extension cord into adaptor and adaptor insert into the wall outlet. (**See Fig. B**), Your entire tree should now be lit.
6. This tree is constructed with Quick Set® and Simple Shape™ technology. Shaping is not necessary; you just need to slightly upsweep all tips and shift branches to fill in any gaps for a fuller, uniform look. Your Christmas tree is now ready to be decorated.

STORAGE INSTRUCTIONS

1. Disconnect green label plug from the wall outlet. Then remove all ornaments and decorations.
2. Disassemble the tree from the top to the bottom. Gently lift the pole straight up to remove from the section below, and fold all branches toward the pole.
3. Close the protective cap on the poles to avoid damaging the internal parts (**Fig. D**).
4. Carefully place all tree sections into the shipping box and tape it shut.
5. Store your tree in a cool, dry place away from sunlight. Exposure to excessive heat or humidity may damage your tree.

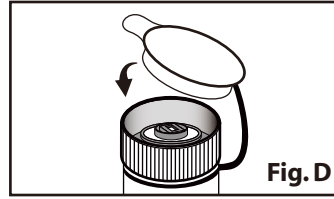

TROUBLESHOOTING TIPS

If The Tree Does Not Illuminate / Some Bulbs Do Not Light or Flicker

1. Check to make sure that the green label plug and the adaptor are properly and firmly.
2. Turn the poles gently to make sure pole to pole are firmly connected.
3. Disconnect from power source, then check for loose, broken or missing light bulbs and replace as needed.

Loose Hinge Pin

1. Place the branch into the slot of bracket.
2. Insert a new hinge pin (included) through the hole, and secure using the retainer washer (**Fig. E**).

SPARE PARTS

This tree includes hinge pins and washers, and spare bulbs. If extra parts are needed, please contact our customer service center.

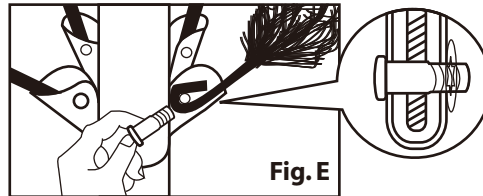

CUSTOMER SERVICE FOR CHRISTMAS TREES

For any questions, assistance or missing parts, **Do Not Return To Place Of Purchase.** Please contact us at 1-888-919-0070 or visit our website at www.polygroup.com. One of our customer service representatives will be happy to assist you.

Tree ID#: _____ Customer Name: _____

Tree UPC#: _____ Address (NO P.O. Boxes): _____

Store Purchased: _____ City & State: _____

Specify Problem: _____ Zip Code: _____

_____ Day Phone: _____

_____ Date Purchased: _____

TREE ID# IS LOCATED ON END PANEL OF BOX. TREE ID# IS REQUIRED WHEN REQUESTING REPLACEMENT PARTS.