

Assembly Instructions

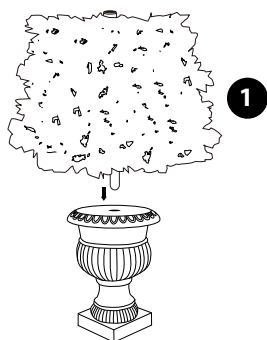

1. Insert tree body into the weighted pot.

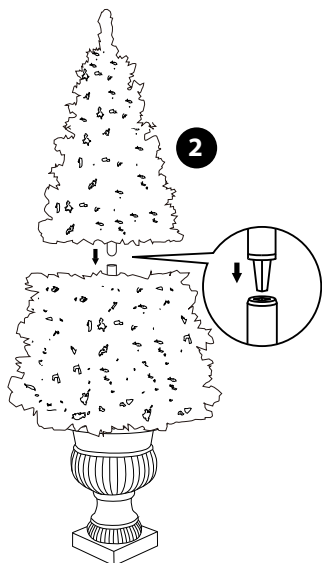

2. Insert the tree top into the trunk of the main body.(as shown in fig.1)

3. Shape the branches. Shift branches to fill any gaps, lightly upsweep all branch tips for a uniform look. Your tree is now ready to decorate.

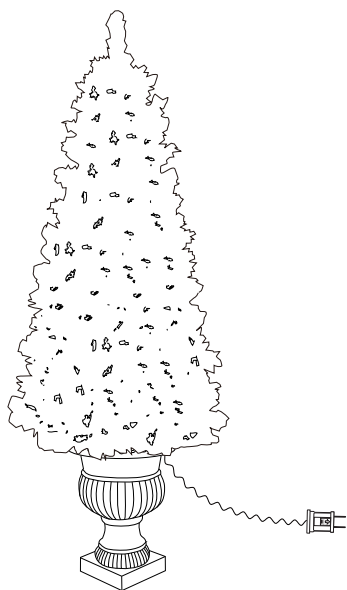

4. Plug the cord into wall outlet.

STORAGE:

- (1) Unplug light string from the wall outlet and remove all ornaments and decorations.
- (2) Gently lift off the top, and remove the bottom section from the tree pot.
- (3) Carefully replace the tree in its box and tape it shut.

DO NOT STORE TREE IN A DAMP AREA OR IN AN AREA WHERE THE TEMPERATURE EXCEEDS 100° F.

MODEL #: TV40M3V05C00